

---

**TruSys® FLEX TRUNKING SYSTEM ON/OFF**

---

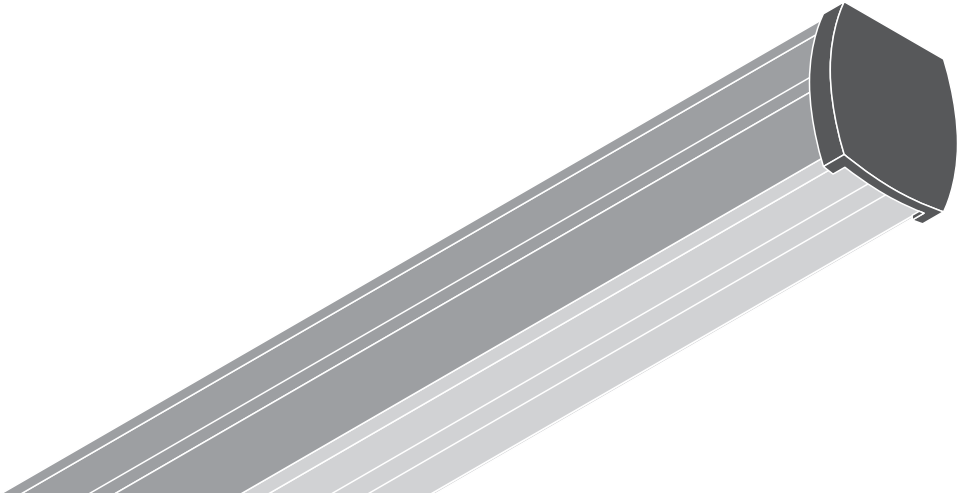

|                                   | EAN           | l x w x h<br>[mm] | W  | VAC      | Hz      | lm    | lm/W |
|-----------------------------------|---------------|-------------------|----|----------|---------|-------|------|
| TRUSYS FLEX P 35W 840 VW CL WT    | 4058075771017 | 1500x77.7x39.4    | 35 | 220-240V | 50/60Hz | 6000  | 175  |
| TRUSYS FLEX P 35W 840 W CL WT     | 4058075771093 | 1500x77.7x39.4    | 35 | 220-240V | 50/60Hz | 6000  | 175  |
| TRUSYS FLEX P 35W 840 N CL WT     | 4058075771307 | 1500x77.7x39.4    | 35 | 220-240V | 50/60Hz | 6000  | 175  |
| TRUSYS FLEX P 35W 840 VN CL WT    | 4058075771345 | 1500x77.7x39.4    | 35 | 220-240V | 50/60Hz | 6000  | 175  |
| TRUSYS FLEX P 35W 840 DS CL WT    | 4058075771383 | 1500x77.7x39.4    | 35 | 220-240V | 50/60Hz | 6000  | 175  |
| TRUSYS FLEX P 35W 840 W OP WT     | 4058075771406 | 1500x77.7x39.4    | 35 | 220-240V | 50/60Hz | 5800  | 167  |
| TRUSYS FLEX P 50W 840 VW CL WT    | 4058075771444 | 1500x77.7x39.4    | 50 | 220-240V | 50/60Hz | 8600  | 175  |
| TRUSYS FLEX P 50W 840 W CL WT     | 4058075771482 | 1500x77.7x39.4    | 50 | 220-240V | 50/60Hz | 8600  | 175  |
| TRUSYS FLEX P 50W 840 N CL WT     | 4058075771574 | 1500x77.7x39.4    | 50 | 220-240V | 50/60Hz | 8600  | 175  |
| TRUSYS FLEX P 50W 840 VN CL WT    | 4058075771604 | 1500x77.7x39.4    | 50 | 220-240V | 50/60Hz | 8600  | 175  |
| TRUSYS FLEX P 50W 840 DS CL WT    | 4058075771802 | 1500x77.7x39.4    | 50 | 220-240V | 50/60Hz | 8600  | 175  |
| TRUSYS FLEX P 50W 840 W OP WT     | 4058075771826 | 1500x77.7x39.4    | 50 | 220-240V | 50/60Hz | 8300  | 167  |
| TRUSYS FLEX P 70W 840 VW CL WT    | 4058075771840 | 1500x77.7x39.4    | 70 | 220-240V | 50/60Hz | 12100 | 175  |
| TRUSYS FLEX P 70W 840 W CL WT     | 4058075771864 | 1500x77.7x39.4    | 70 | 220-240V | 50/60Hz | 12100 | 175  |
| TRUSYS FLEX P 70W 840 N CL WT     | 4058075771888 | 1500x77.7x39.4    | 70 | 220-240V | 50/60Hz | 12100 | 175  |
| TRUSYS FLEX P 70W 840 VN CL WT    | 4058075771925 | 1500x77.7x39.4    | 70 | 220-240V | 50/60Hz | 12100 | 175  |
| TRUSYS FLEX P 70W 840 DS CL WT    | 4058075771994 | 1500x77.7x39.4    | 70 | 220-240V | 50/60Hz | 12100 | 175  |
| TRUSYS FLEX P 70W 840 W OP WT     | 4058075772090 | 1500x77.7x39.4    | 70 | 220-240V | 50/60Hz | 11700 | 167  |
| TRUSYS FLEX P RAIL 1500 5P WT     | 4058075781672 | 1650x70.2x38.8    | -  | -        | -       | -     | -    |
| TRUSYS FLEX P RAIL 1500 5P END WT | 4058075781733 | 1500x70.2x38.8    | -  | -        | -       | -     | -    |
| TRUSYS FLEX P RAIL 3000 5P WT     | 4058075781757 | 3150x70.2x38.8    | -  | -        | -       | -     | -    |
| TRUSYS FLEX P RAIL 4500 5P WT     | 4058075793156 | 4650x70.2x38.8    | -  | -        | -       | -     | -    |

|                                   | EAN           | K    | IP | IK | ∇       | R <sub>a</sub> | °(°C)     | PF    | ⊙ | 👤      |
|-----------------------------------|---------------|------|----|----|---------|----------------|-----------|-------|---|--------|
| TRUSYS FLEX P 35W 840 VW CL WT    | 4058075771017 | 4000 | 40 | 04 | 120°    | ≥80            | -20...+40 | ≥0.95 | - | 1.7 kg |
| TRUSYS FLEX P 35W 840 W CL WT     | 4058075771093 | 4000 | 40 | 04 | 90°     | ≥80            | -20...+40 | ≥0.95 | - | 1.7 kg |
| TRUSYS FLEX P 35W 840 N CL WT     | 4058075771307 | 4000 | 40 | 04 | 60°     | ≥80            | -20...+40 | ≥0.95 | - | 1.7 kg |
| TRUSYS FLEX P 35W 840 VN CL WT    | 4058075771345 | 4000 | 40 | 04 | 30°     | ≥80            | -20...+40 | ≥0.95 | - | 1.7 kg |
| TRUSYS FLEX P 35W 840 DS CL WT    | 4058075771383 | 4000 | 40 | 04 | 2 x 30° | ≥80            | -25...+40 | ≥0.95 | - | 1.7 kg |
| TRUSYS FLEX P 35W 840 W OP WT     | 4058075771406 | 4000 | 40 | 04 | 90°     | ≥80            | -20...+40 | ≥0.95 | - | 1.7 kg |
| TRUSYS FLEX P 50W 840 VW CL WT    | 4058075771444 | 4000 | 40 | 04 | 120°    | ≥80            | -20...+40 | ≥0.95 | - | 1.7 kg |
| TRUSYS FLEX P 50W 840 W CL WT     | 4058075771482 | 4000 | 40 | 04 | 90°     | ≥80            | -20...+40 | ≥0.95 | - | 1.7 kg |
| TRUSYS FLEX P 50W 840 N CL WT     | 4058075771574 | 4000 | 40 | 04 | 60°     | ≥80            | -20...+40 | ≥0.95 | - | 1.7 kg |
| TRUSYS FLEX P 50W 840 VN CL WT    | 4058075771604 | 4000 | 40 | 04 | 30°     | ≥80            | -20...+40 | ≥0.95 | - | 1.7 kg |
| TRUSYS FLEX P 50W 840 DS CL WT    | 4058075771802 | 4000 | 40 | 04 | 2 x 30° | ≥80            | -20...+40 | ≥0.95 | - | 1.7 kg |
| TRUSYS FLEX P 50W 840 W OP WT     | 4058075771826 | 4000 | 40 | 04 | 90°     | ≥80            | -20...+40 | ≥0.95 | - | 1.7 kg |
| TRUSYS FLEX P 70W 840 VW CL WT    | 4058075771840 | 4000 | 40 | 04 | 120°    | ≥80            | -20...+40 | ≥0.95 | - | 1.7 kg |
| TRUSYS FLEX P 70W 840 W CL WT     | 4058075771864 | 4000 | 40 | 04 | 90°     | ≥80            | -20...+40 | ≥0.95 | - | 1.7 kg |
| TRUSYS FLEX P 70W 840 N CL WT     | 4058075771888 | 4000 | 40 | 04 | 60°     | ≥80            | -20...+40 | ≥0.95 | - | 1.7 kg |
| TRUSYS FLEX P 70W 840 VN CL WT    | 4058075771925 | 4000 | 40 | 04 | 30°     | ≥80            | -20...+40 | ≥0.95 | - | 1.7 kg |
| TRUSYS FLEX P 70W 840 DS CL WT    | 4058075771994 | 4000 | 40 | 04 | 2 x 30° | ≥80            | -20...+40 | ≥0.95 | - | 1.7 kg |
| TRUSYS FLEX P 70W 840 W OP WT     | 4058075772090 | 4000 | 40 | 04 | 90°     | ≥80            | -20...+40 | ≥0.95 | - | 1.7 kg |
| TRUSYS FLEX P RAIL 1500 5P WT     | 4058075781672 | -    | -  | 04 | -       | -              | -         | -     | - | 1.6 kg |
| TRUSYS FLEX P RAIL 1500 5P END WT | 4058075781733 | -    | -  | 04 | -       | -              | -         | -     | - | 1.4 kg |
| TRUSYS FLEX P RAIL 3000 5P WT     | 4058075781757 | -    | -  | 04 | -       | -              | -         | -     | - | 3.0 kg |
| TRUSYS FLEX P RAIL 4500 5P WT     | 4058075793156 | -    | -  | 04 | -       | -              | -         | -     | - | 4.2 kg |

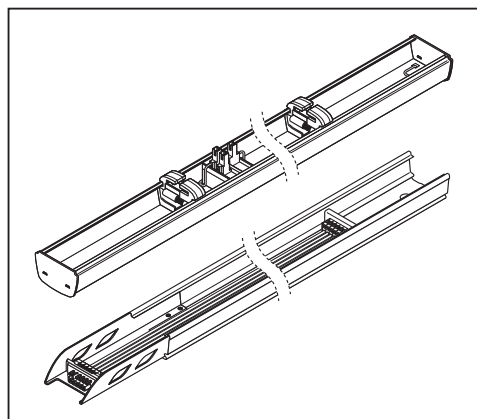

**TRUSYS FLEX  
SURFACE CLIP**  
EAN 4058075781894

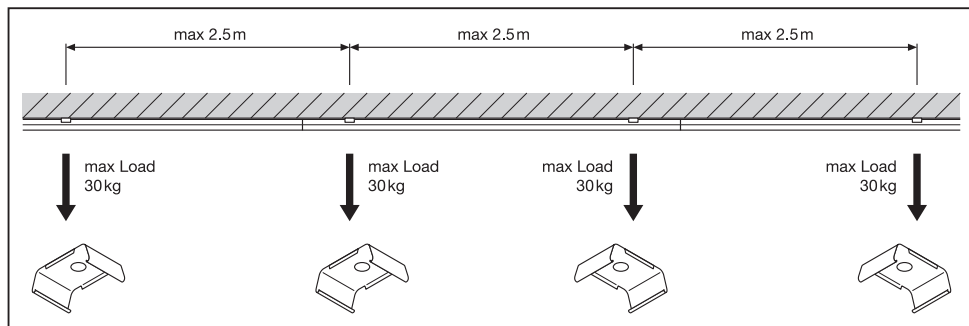
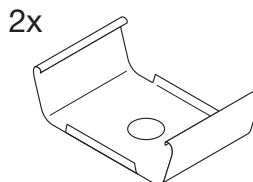

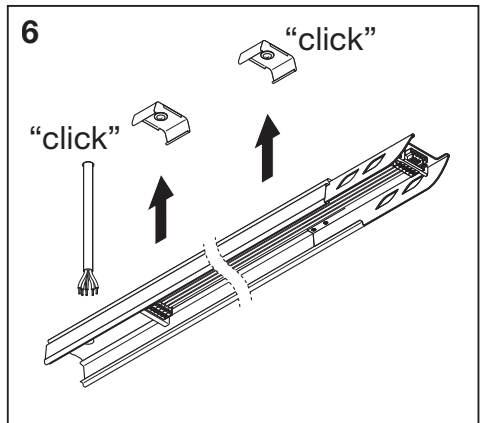
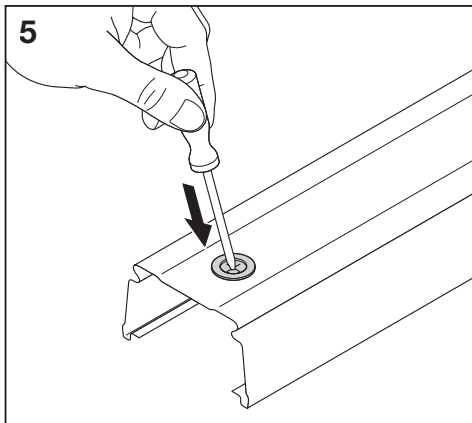
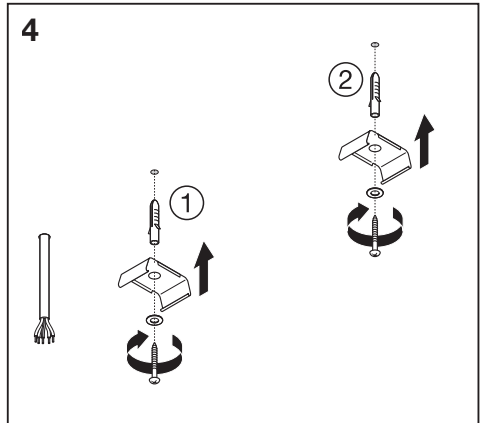
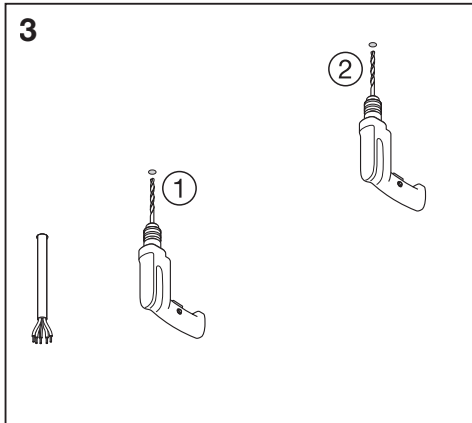
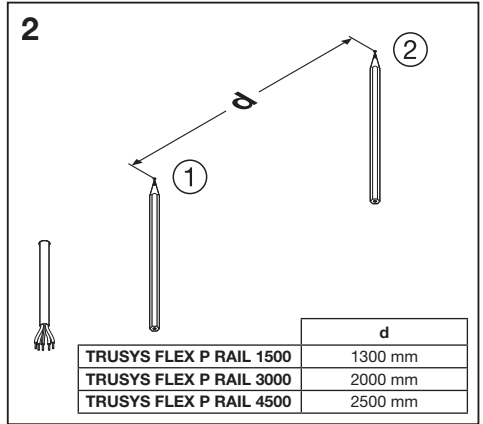
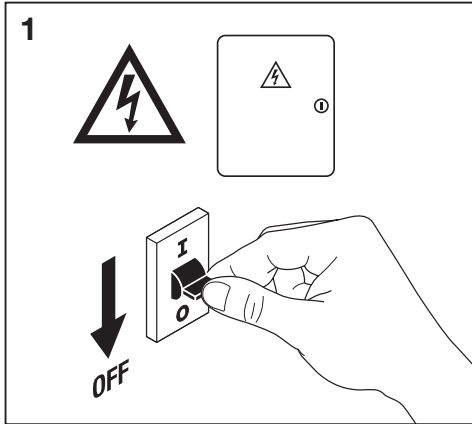

**TRUSYS FLEX FEED IN 5P**  
EAN 4058075781931

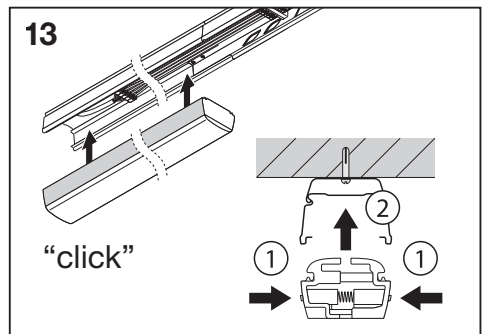
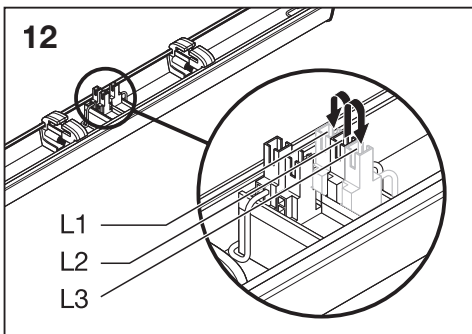
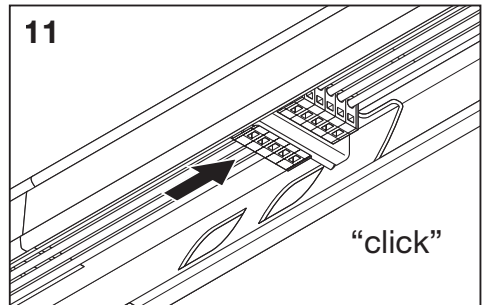
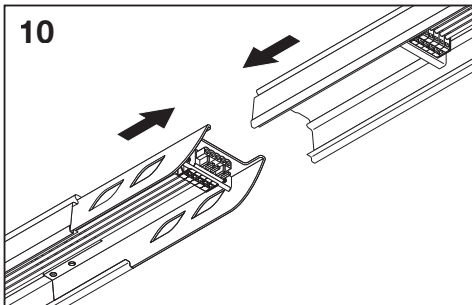
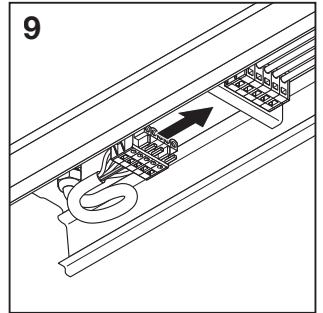
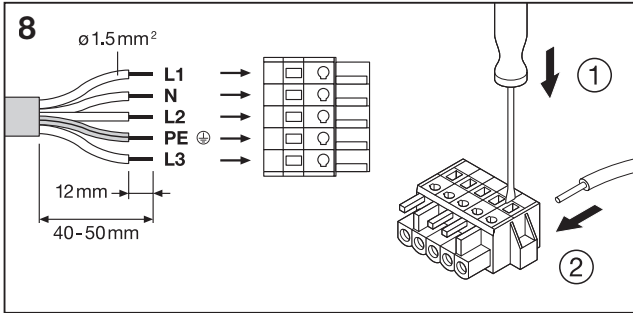
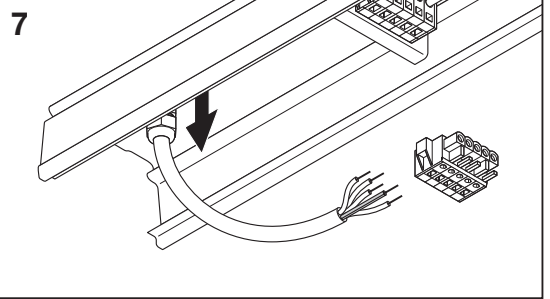
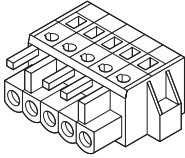

**TRUSYS FLEX**  
**END CAP RAIL WT**  
EAN 4058075781856

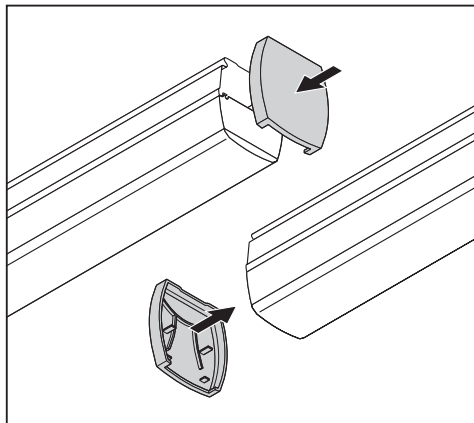
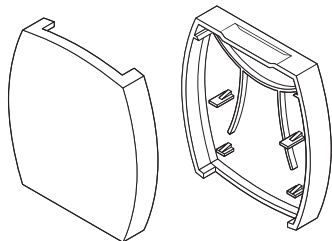

**TRUSYS FLEX**  
**END CAP LOW RAIL WT**  
EAN 4058075781870

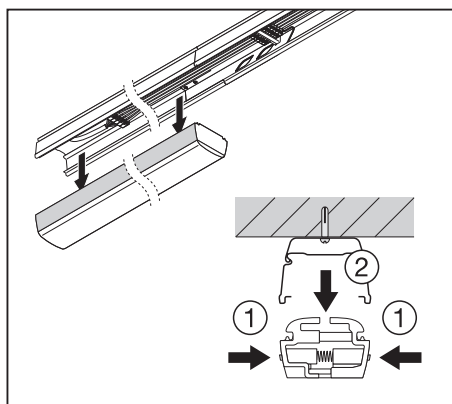
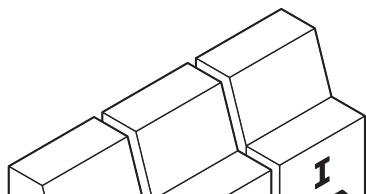
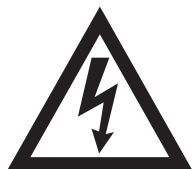
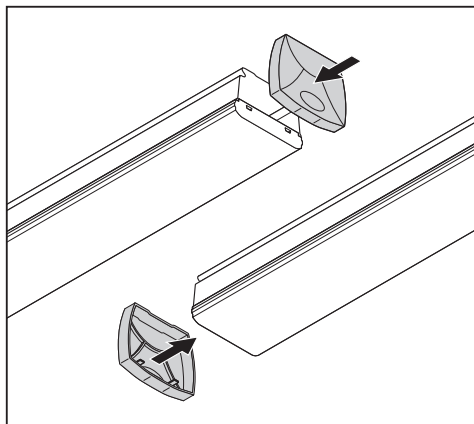
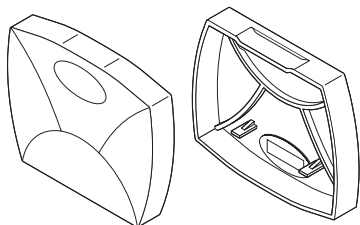

### TRUSYS FLEX SUSPENSION KIT

EAN 4058075781795

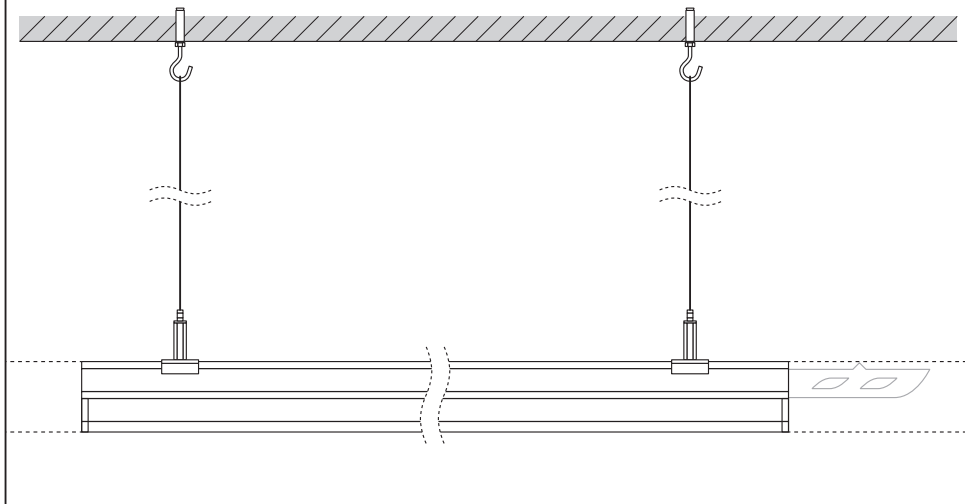
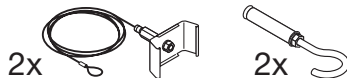

### TRUSYS FLEX CHAIN KIT

EAN 4058075781818

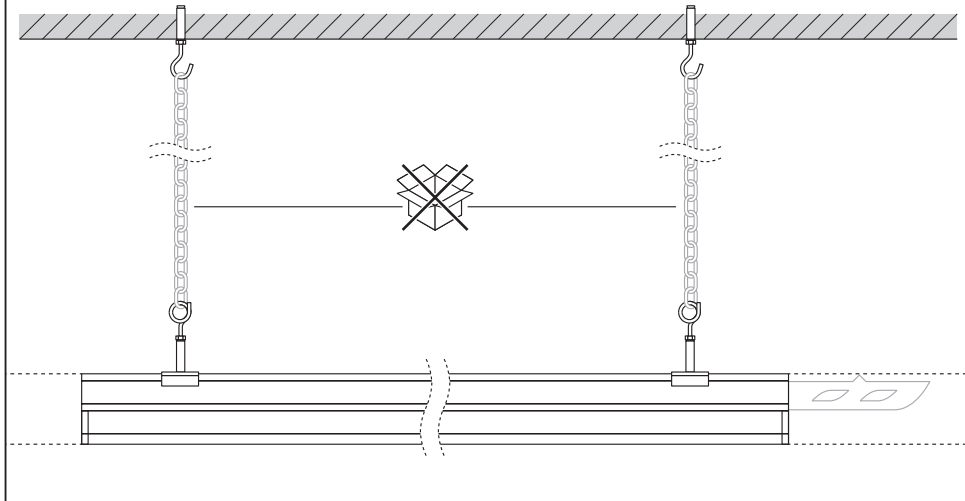
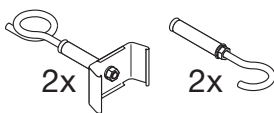

**TRUSYS FLEX GRID CEILING CLIP**

EAN 4058075781917

2x

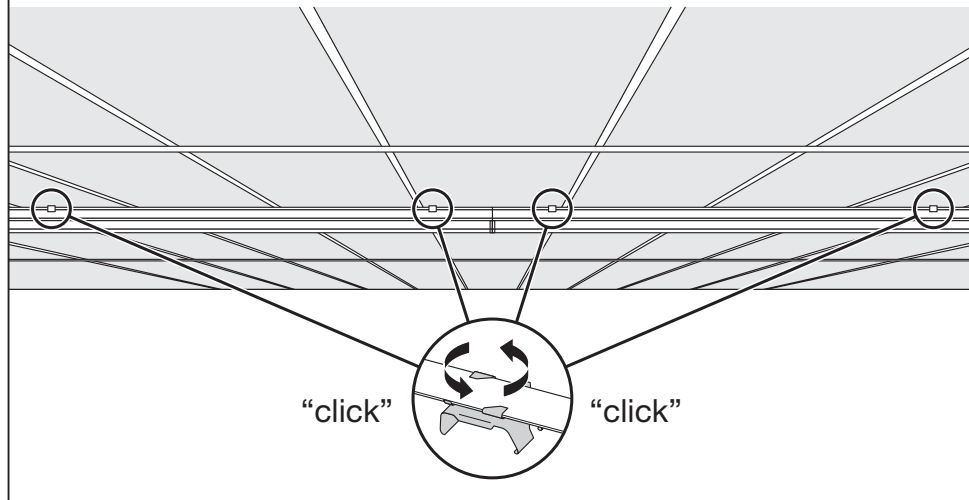
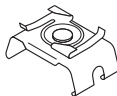

**TRUSYS FLEX BLIND COVER WT**

EAN 4058118270828

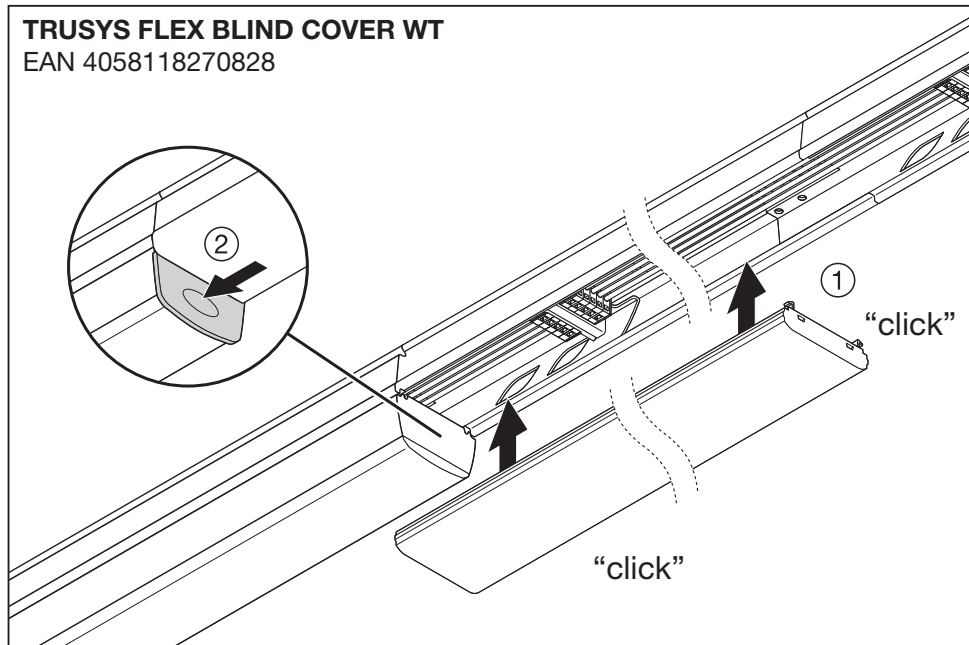

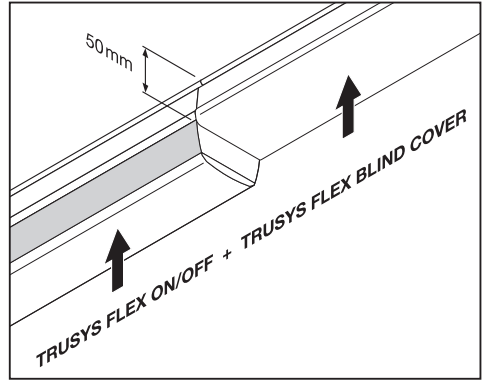
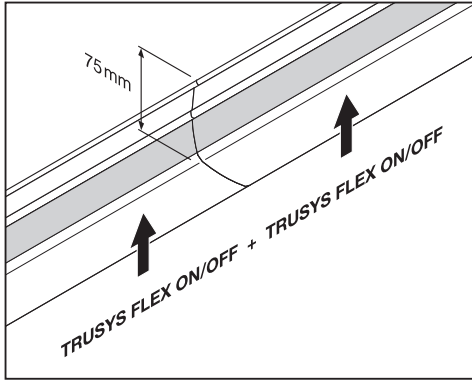

|                            | 1x TRUSYS FLEX P RAIL | 2x TRUSYS FLEX P RAIL | ... | nx TRUSYS FLEX P RAIL | 1x TRUSYS FLEX P RAIL END |
|----------------------------|-----------------------|-----------------------|-----|-----------------------|---------------------------|
|                            |                       |                       |     |                       |                           |
|                            | <b>C10 A</b>          | <b>B16 A</b>          |     | <b>C16 A</b>          | <b>Inrush current</b>     |
|                            |                       |                       |     |                       | <b>Inrush Charge Time</b> |
| <b>TRUSYS FLEX 35W 840</b> | 17                    | 22                    |     | 27                    | 27.5 A                    |
| <b>TRUSYS FLEX 50W 840</b> | 10                    | 13                    |     | 17                    | 32 A                      |
| <b>TRUSYS FLEX 70W 840</b> | 7                     | 8                     |     | 12                    | 38.8 A                    |

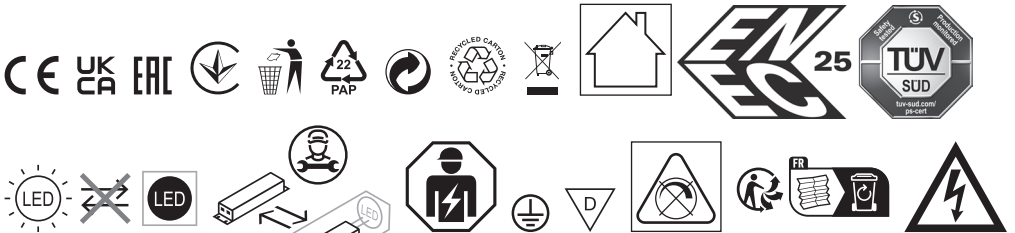

**FR**  
Cet appareil et ses accessoires se recyclent

À DÉPOSER EN MAGASIN  
OU  
À DÉPOSER EN DÉCHÈTERIE

Points de collecte sur [www.quefairede mesdechets.fr](http://www.quefairede mesdechets.fr)

C10449058  
G11141763  
14.07.22



LEDVANCE GmbH  
Steinerne Furt 62  
86167 Augsburg, Germany  
[www.ledvance.com](http://www.ledvance.com)

© LEDVANCE Ltd, Aquila House  
Delta Crescent, Westbrook, Warrington  
WA5 7NR, United Kingdom